

REV.	DESCRIPTION	DRAWN	CHECKED	APPROVED
A	NEW RELEASE	YCH 03/24/09	~	

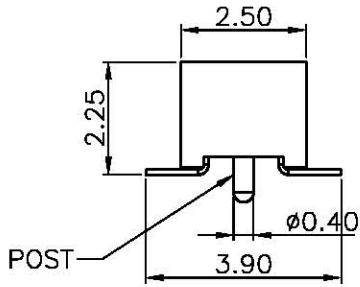
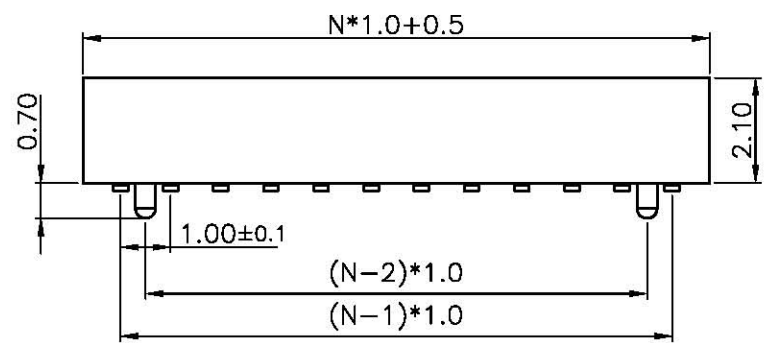
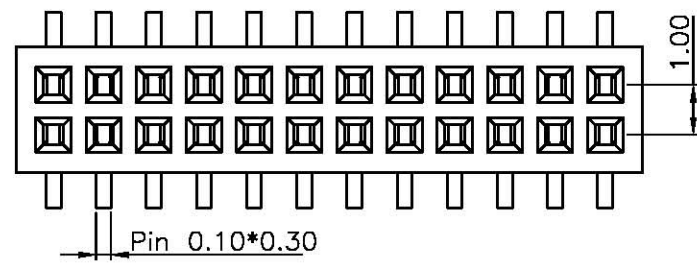

NOTES:

1. SPECIFICATIONS

- . Current Rating: 1.0A
- . Insulation Resistance: 500MΩ Min
- . Dielectric Withstanding: 300V AC
- . Contact Resistance: 20mΩ Max
- . Operating Temperature: -45°C to+110°C

2. MATERIALS:

- . Housing: High temperature, Nylon-46
- . Contact: Copper alloy

3.PRODUCT NUMBER CODE:

DS1065-12 - X X X X X

- PACKING TYPE  
T:TRAY  
R:TAPE ON REEL  
B:TUBE
- PICK UP SUPPORT  
S:W/ PICK UP  
X:W/O PICK UP
- HOUSING COLOR  
B:BLACK
- CONTACT PLATING  
8: FULL GOLD FLASH  
6: FULL TIN  
0: SELECTIVE GOLD FLASH
- No.OF CONTACTS  
2\*2-2\*40

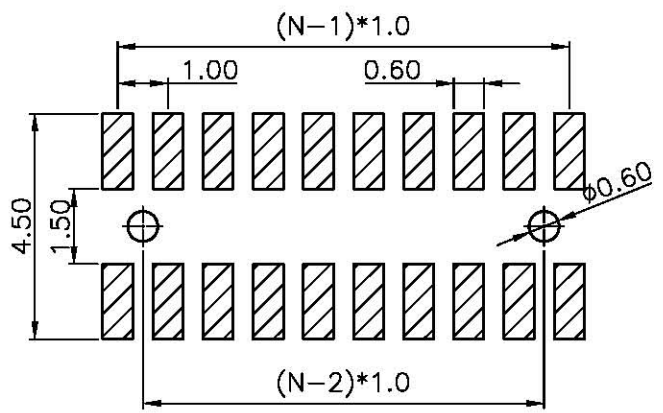

RECOMMEND PCB LAYOUT(TOLERANCE ±0.05)

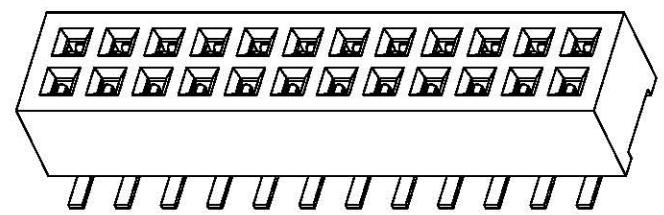

GENERAL TOLERANCE		ANGLE TOLERANCE		PROJECTION	TITLE	FEMALE HEADER PITCH 1.00mm	
X.	±0.60	X.	±5°	mm		SMT TYPE W/POST	
.X	±0.38	.X	±3°				
.XX	±0.25	.XX	±2°		SHEET SIZE	A4	SERIES DS1065-12
DRAWING TYPE		CUSTOMER					
SCALE		1:1	SHEET	1 OF 1			
DRAWING NO.		C-DS1065-12-XXXXX					